

MOVE-IN READY

BUILT SPACE

SUITE 309 | 5,867 RSF



OFFICE CONDOS ON THE EAST RIVER WATERFRONT

SUITE 309 | 5,867 RSF



- RECENTLY UPGRADED PERIMETER OFFICE INSTALLATION WITH
- PRIVATE RESTROOM & PANTRY
- OVERSIZED WALL-TO-WALL WINDOWS & NATURAL LIGHT

EAST 49TH STREET

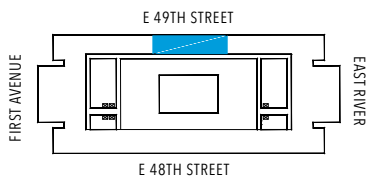
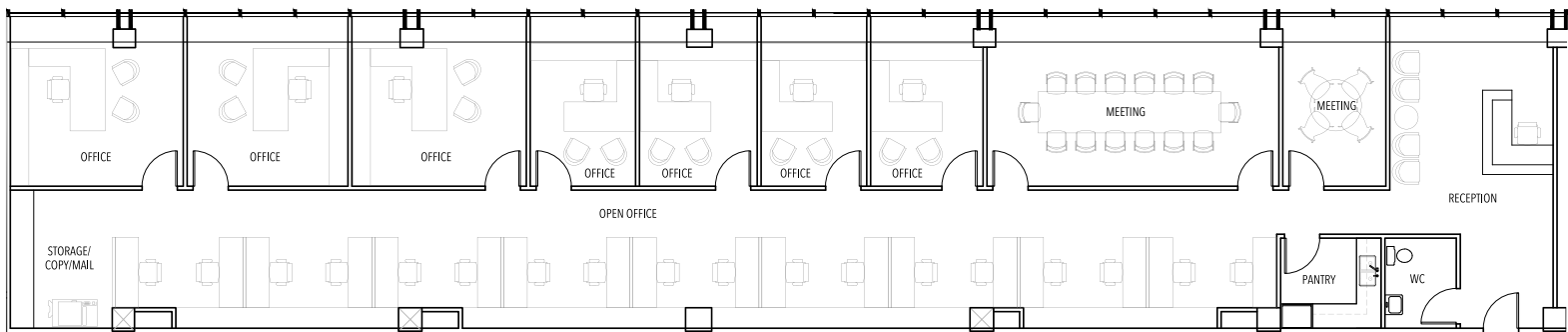

866UNP.COM



JARED HOROWITZ
Vice Chairman
212.372.2022
jhorowitz@ngkf.com

SCOTT KLAU
Vice Chairman
212.372.2244
sklau@ngkf.com

ERIK HARRIS
Executive Managing Director
212.372.2105
eharris@ngkf.com

ZACHARY WEIL
Managing Director
646.441.3744
zweil@ngkf.com

All dimensions and square footages noted are approximate, subject to construction variances, may contain minor variations from floor to floor, may exceed usable floor area and have been calculated as set forth in the Offering Plan. Information contained in this advertisement may contain inaccuracies or typographical errors and is being provided to recipients without warranties or representations of any kind. Subject to the terms of the Offering Plan, Sponsor and its affiliates, service providers, agents and representatives disclaim all express and implied warranties and conditions of any kind, including without limitation or conditions regarding accuracy, timeliness, completeness, quality, or fitness for any purpose or those arising by law, statute, usage of trade or course of dealing. Images are artist's renderings for illustrative purposes only and are subject to change without notice. Proposed configurations may not presently be offered under the Offering Plan and are for discussion purposes only. Sponsor reserves the right to make changes in accordance with the Offering Plan. The complete offering terms are in the Offering Plan. File No. CD14-0202. 866 United Nations Plaza Condominium, 866 United Nations Plaza, New York, NY 10017. Sponsor: 866 Plaza Owner, LLC, 299 Park Avenue, New York, NY 10171.

BUILDING HIGHLIGHTS

- NEWLY RENOVATED LOBBY, ELEVATORS & COMMON AREAS
- STATE-OF-THE-ART SECURITY & ON-SITE PARKING
- EASY ACCESS TO GRAND CENTRAL, PENN, MTA BUSES & FDR DRIVE



NEWLY RENOVATED LOBBY



NEW

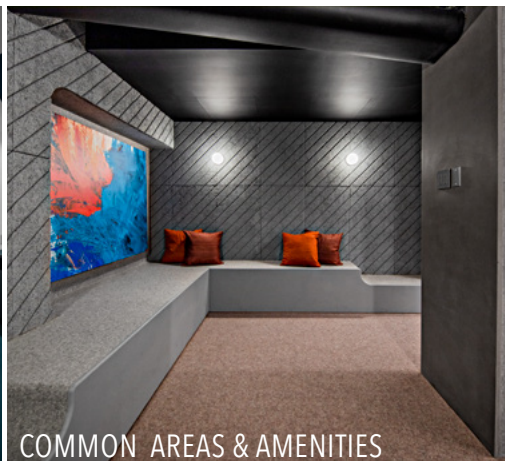

COMMON AREAS & AMENITIES

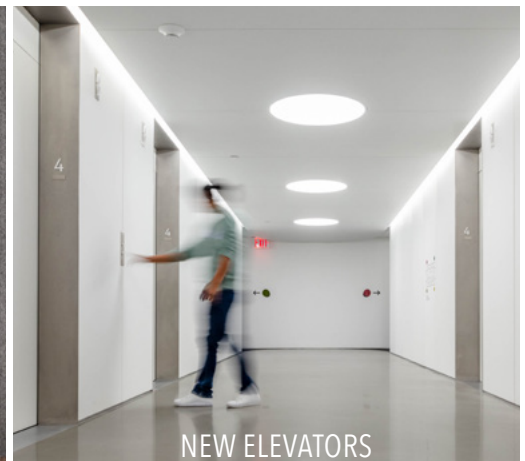

NEW ELEVATORS

ADDITIONAL OWNERSHIP OPPORTUNITIES

UNITS FROM **500 TO 61,576 RSF** | UP TO **120,000 CONTIGUOUS RSF**

866UNP.COM



JARED HOROWITZ
Vice Chairman
212.372.2022
jhorowitz@ngkf.com

SCOTT KLAU
Vice Chairman
212.372.2244
sklau@ngkf.com

ERIK HARRIS
Executive Managing Director
212.372.2105
eharris@ngkf.com

ZACHARY WEIL
Managing Director
646.441.3744
zweil@ngkf.com

All dimensions and square footages noted are approximate, subject to construction variances, may contain minor variations from floor to floor, may exceed usable floor area and have been calculated as set forth in the Offering Plan. Information contained in this advertisement may contain inaccuracies or typographical errors and is being provided to recipients without warranties or representations of any kind. Subject to the terms of the Offering Plan, Sponsor and its affiliates, service providers, agents and representatives disclaim all express and implied warranties and conditions of any kind, including without limitation or conditions regarding accuracy, timeliness, completeness, quality, or fitness for any purpose or those arising by law, statute, usage of trade or course of dealing. Images are artist's renderings for illustrative purposes only and are subject to change without notice. Proposed configurations may not presently be offered under the Offering Plan and are for discussion purposes only. Sponsor reserves the right to make changes in accordance with the Offering Plan. The complete offering terms are in the Offering Plan. File No. CD14-0202. 866 United Nations Plaza Condominium, 866 United Nations Plaza, New York, NY 10017. Sponsor: 866 Plaza Owner, LLC, 299 Park Avenue, New York, NY 10171.